

ADJUSTMENT

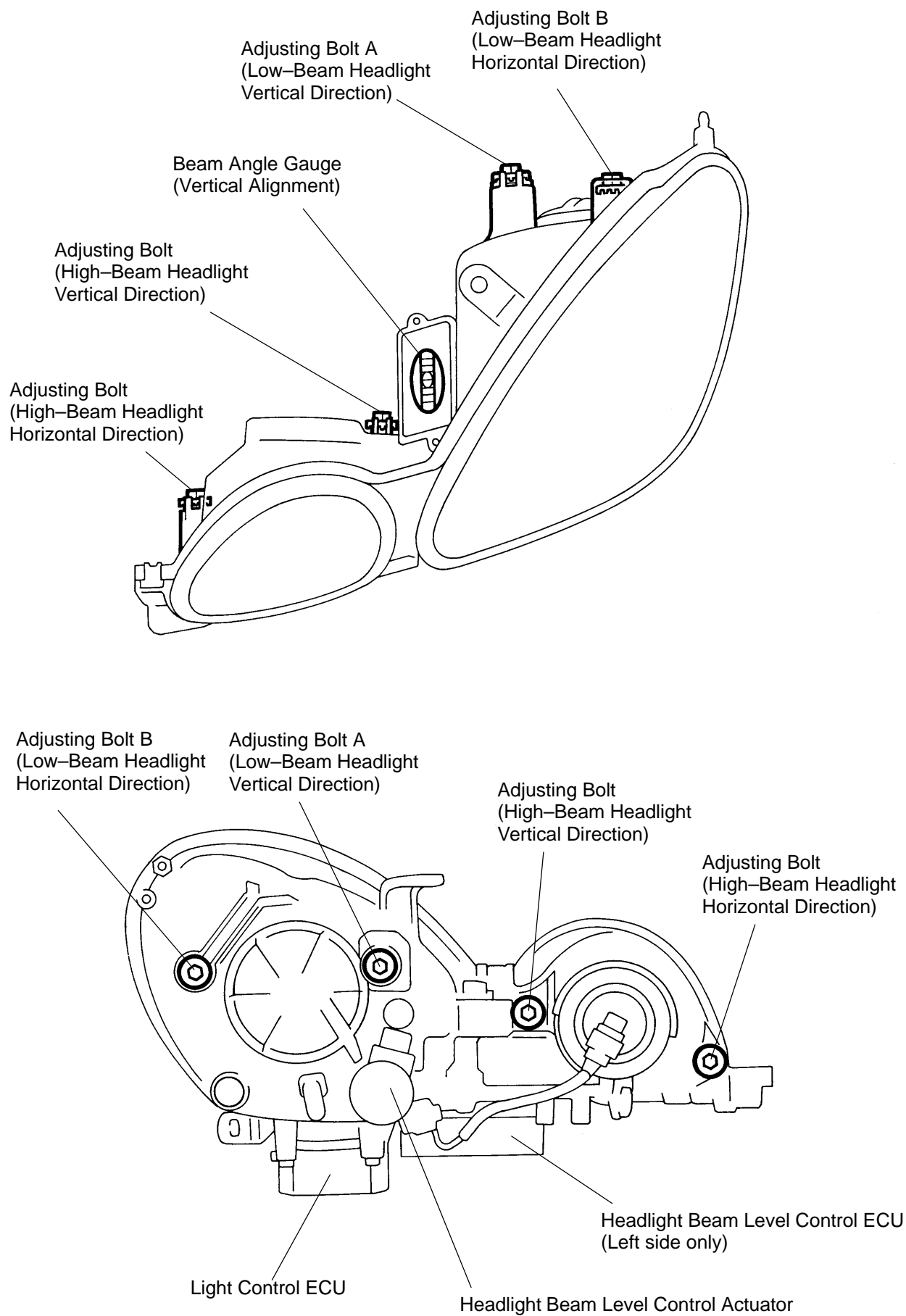

1. ADJUST HEADLIGHT AIMMING**(a) Inspect the headlights aiming.**

Do the following items before inspection.

- Make sure the body around the headlight is not deformed.
- Park the vehicle on a level spot.
- The driver gets into the driver's seat and puts the vehicle in a state ready for driving (with a full tank).
- Bounce the vehicle several times.

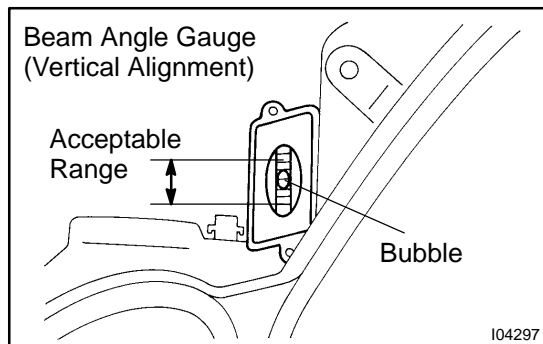
**(b) Adjust the headlight aiming.**

- **Vertical Alignment:**
If the bubble is out of the acceptable range of the beam angle gauge, adjust it using bolt A.

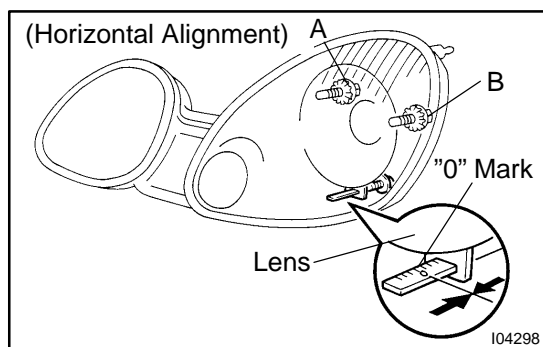

- **Horizontal Alignment:**
If the edge of the lens does not match "0" mark, adjust the lens using bolt B.

HINT:

After adjusting the headlight in vertical direction, check that the light has been shifted from the adjusted position in the horizontal direction.

2. REPLACE HEADLIGHT**(a) Replace the headlight.****(b) Place the vehicle in the following conditions.**

- The area around the headlight is not deformed.
- The vehicle is parked on a level surface.
- Tire inflation pressure is the specified value.
- A driver is in the driver's seat and the vehicle is in a state ready for driving (with a tank full).
- The vehicle has been bounced several times.

(c) Check the headlight aiming.

- (1) Prepare a thick white paper.
- (2) Stand the paper perpendicular to the ground at the position 9.84 ft away from the headlights.
- (3) Ensure that the center line of the vehicle and the paper face forms a 90-degree angle as shown in the illustration.

- (4) Draw a horizontal line (H line) on the paper, showing where the headlights should strike.
- (5) Draw a vertical line (V line) to where the center line of the vehicle is to be.
- (6) Draw 2 vertical lines to where the both headlights should strike (V RH and V LH lines).
- (7) Draw a horizontal line (by connecting the both low beam center marks) to where the headlights should strike (H RH and H LH lines).

HINT:

The H RH and H LH line is 0.4° below the horizontal line (H line) of the light axis.

- (8) Start the engine.
- (9) Turn the headlights ON.
- (10) Check that the headlights properly strike the position shown in the illustration.
- (11) If not, adjust the lights in the vertical or horizontal direction.

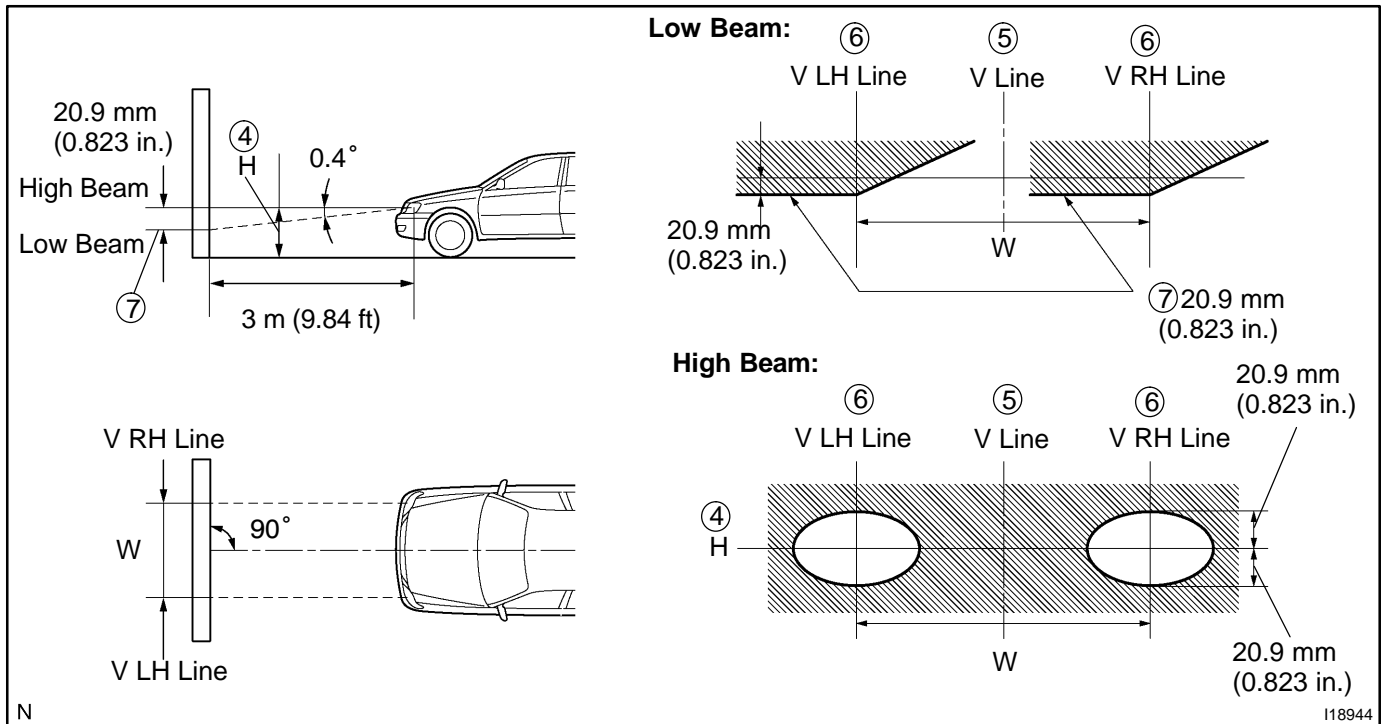
**HINT:**

As shown in the illustration, adjust each aim of the RH and LH lights.

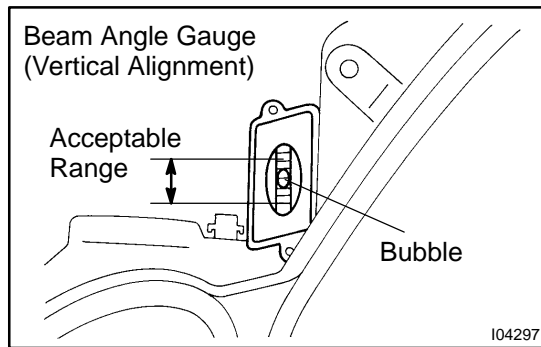

- (d) Vertical Alignment:
Adjust the headlight aiming.
- (1) Using adjustment bolt A, adjust the headlight aiming to within the specification.
 - (2) Make sure the gauge bubble is within the acceptable range.

HINT:

If the gauge bubble is outside the acceptable range, check that the vehicle is parked on a level spot.

Readjust the headlight aiming after parking the vehicle on a level spot.

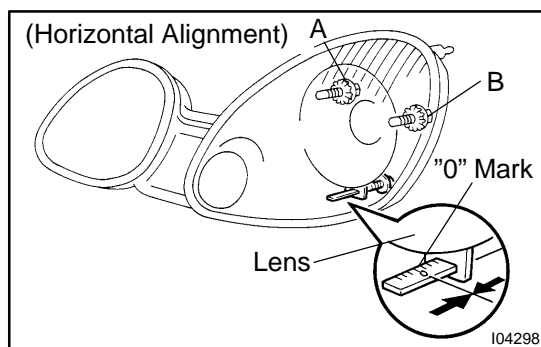

- (e) Horizontal Alignment:
Adjust the headlight aiming.
- If the edge of the lens does not match the paper as shown in the illustration, adjust the lens using bolt B. (See step 5)

HINT:

After adjusting the headlight in vertical direction, check that the light has been shifted from the adjusted position in the horizontal direction.